

STRAIGHT COUPLING

Type: **1035...1** Body

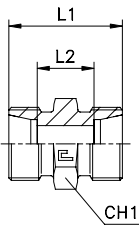

Type: **1035.. B3** Ring

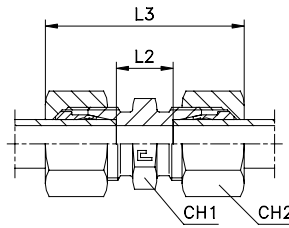

Type: **1035...4** B4 Ring

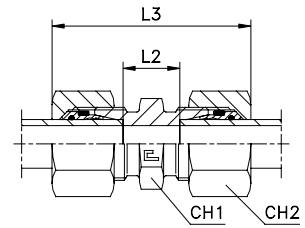

Series DIN	10.... [bar]	11.... [bar]	Ordering Body	Ordering Equipped B3	Ø Tube	L1	L2	L3	CH1	CH2	Ordering Equipped B4
LL	100	100	103501.1	103501	4	20	12	31	12	10	-
			103502.1	103502	6	20	9	32	12	12	-
			103503.1	103503	8	23	12	35	12	14	-
L	500	315	103504.1	103504	6	24	10	39	12	14	103504.4
			103505.1	103505	8	25	11	40	14	17	103505.4
			103506.1	103506	10	27	13	42	17	19	103506.4
	103507.1		103507	12	28	14	43	19	22	103507.4	
	103508.1		103508	15	30	16	46	24	27	103508.4	
	103509.1		103509	18	31	16	48	27	32	103509.4	
	250	160	103510.1	103510	22	35	20	52	32	36	103510.4
			103511.1	103511	28	36	21	54	41	41	103511.4
			103512.1	103512	35	41	20	63	46	50	103512.4
S	800	630	103513.1	103513	42	43	21	66	55	60	103513.4
			103514.1	103514	6	30	16	45	14	17	103514.4
			103515.1	103515	8	32	18	47	17	19	103515.4
	630	630	103516.1	103516	10	32	17	49	19	22	103516.4
			103517.1	103517	12	34	19	51	22	24	103517.4
			103518.1	103518	14	38	22	57	24	27	103518.4
	420	400	103519.1	103519	16	38	21	57	27	30	103519.4
			103520.1	103520	20	44	23	66	32	36	103520.4
			103521.1	103521	25	50	26	74	41	46	103521.4
315	315	103522.1	103522	30	54	27	80	46	50	103522.4	
		103523.1	103523	38	61	29	90	55	60	103523.4	

Note: If you wish to order AISI 316 stainless steel fittings, please change the first two digits from **10....** to **11....** .
If you wish to order AISI 316 stainless steel fittings with AISI 304 stainless steel nuts, please change the first two digits from **10....** to **14....** .

BULKHEAD CONNECTION

Type: **1036...1** Body

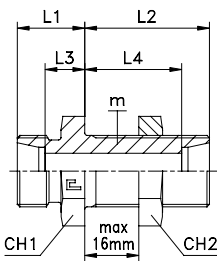

Type: **1036.. B3** Ring

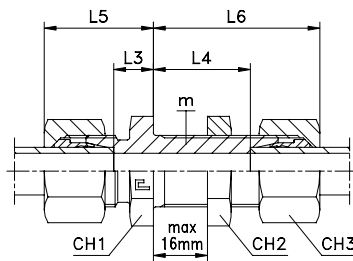

Type: **1036...4** B4 Ring

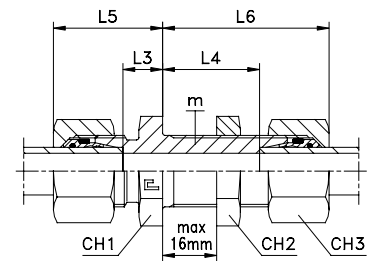

Series	10.... [bar]	11.... [bar]	Ordering Body	Ordering Equipped B3	Ø Tube	m	L1	L2	L3	L4	L5	L6	CH1	CH2	CH3	Ordering Equipped B4	
L	500	315	103604.1	103604	6	12x1,5	14	34	7	27	22	42	17	17	14	103604.4	
			103605.1	103605	8	14x1,5	15	34	8	27	23	23	42	19	19	17	103605.4
			103606.1	103606	10	16x1,5	17	35	10	28	25	43	22	22	19	19	103606.4
	103607.1		103607	12	18x1,5	17	36	10	29	25	44	24	24	22	22	103607.4	
	103608.1		103608	15	22x1,5	19	38	12	31	27	46	27	30	27	27	103608.4	
	103609.1		103609	18	26x1,5	21	40	13,5	32,5	30	49	32	36	32	32	103609.4	
	250	160	103610.1	103610	22	30x2	24	42	16,5	34,5	33	51	36	41	36	103610.4	
			103611.1	103611	28	36x2	26	43	18,5	35,5	35	52	41	46	41	103611.4	
			103612.1	103612	35	45x2	29	47	18,5	36,5	40	58	50	55	50	103612.4	
S	800	630	103613.1	103613	42	52x2	30	47	19	36	42	59	60	65	60	103613.4	
			103614.1	103614	6	14x1,5	19	36	12	29	27	44	19	19	17	103614.4	
			103615.1	103615	8	16x1,5	20	36	13	29	28	44	22	22	19	103615.4	
	630	630	103616.1	103616	10	18x1,5	22	37	14,5	29,5	31	46	24	24	22	103616.4	
			103617.1	103617	12	20x1,5	22	38	14,5	30,5	31	47	27	27	24	103617.4	
			103618.1	103618	14	22x1,5	25	40	17	32	35	50	30	30	27	103618.4	
	420	400	103619.1	103619	16	24x1,5	25	40	16,5	31,5	35	50	32	32	30	103619.4	
			103620.1	103620	20	30x2	28	44	17,5	33,5	39	55	41	41	36	103620.4	
			103621.1	103621	25	36x2	32	47	20	35	44	59	46	46	46	103621.4	
315	315	103622.1	103622	30	42x2	35	51	21,5	37,5	48	64	50	50	50	103622.4		
		103623.1	103623	38	52x2	38	53	22	37	53	68	65	65	60	103623.4		

Note: If you wish to order AISI 316 stainless steel fittings, please change the first two digits from **10....** to **11....** .
If you wish to order AISI 316 stainless steel fittings with AISI 304 stainless steel nuts, please change the first two digits from **10....** to **14....** .